

Parts Information:
**Engine Stand Rear Wheel Drive Axle
 Adaptor**
Model No: ESAS01

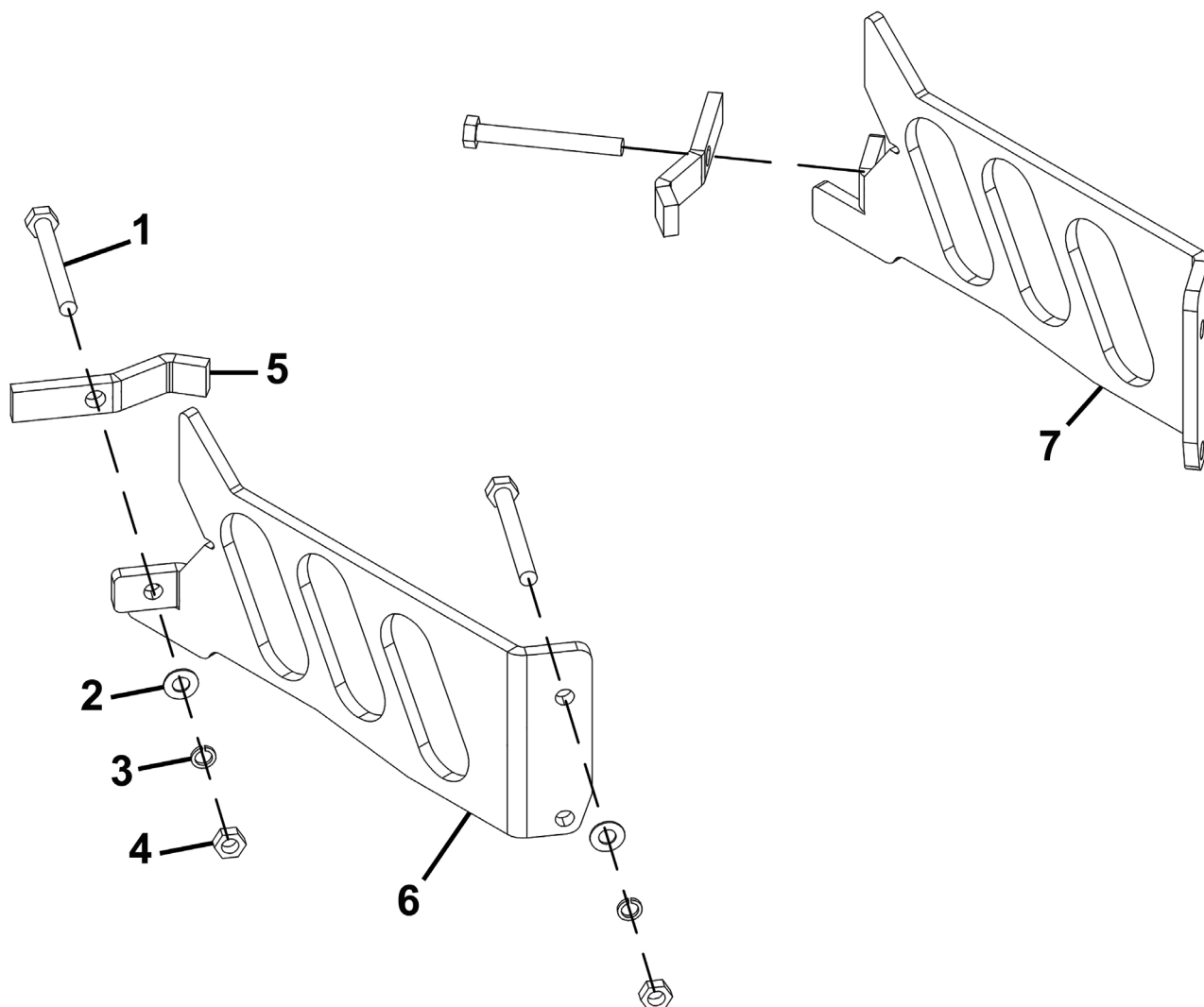

Item	Part No.	Description	Qty
1	HHB12100.S	Hex Head Bolt M12 X 100mm	6
2	FWM12.S	Flat Washer M12 Zinc	6
3	SWM12.S	Spring Washer M12 Zinc	6
4	SN12.S	Steel Nut M12 Zinc	6

Item	Part No.	Description	Qty
5	ESAS01-05	Clamping Bar	2
6	ESAS01-06	Right Arm	1
7	ESAS01-07	Left Arm	1

NOTE: It is our policy to continually improve products and as such we reserve the right to alter data, specifications and component parts without prior notice. There may be alternative versions of this product, please contact us should you require this information.

IMPORTANT: No liability is accepted for incorrect use of product. Spare parts must be fitted by a competent person

WARRANTY: Guarantee is 12 months from purchase date, proof of which will be required for any claim.

Jack Sealey Ltd t/a Sealey Group, Kempson Way, Suffolk Business Park, Bury St Edmunds, Suffolk, IP32 7AR UK

Jack Sealey (EU) Ltd t/a Sealey Group, Farney Street, Carrickmacross, Co. Monaghan, A81 PK68 Ireland

Tel: 01284 757500 • **Email:** sales@sealey.co.uk • **Web:** www.sealey.co.uk