



INSTRUCTIONS FOR
**WHEEL STORAGE TROLLEY 100KG CAPACITY
WITH HANDLE**
MODEL NO: **STR005.V2**

Thank you for purchasing a Sealey product. Manufactured to a high standard, this product will, if used according to these instructions and maintained properly, give you years of trouble free performance.

IMPORTANT: PLEASE READ THESE INSTRUCTIONS CAREFULLY. NOTE THE SAFE OPERATIONAL REQUIREMENTS, WARNINGS & CAUTIONS. USE THE PRODUCT CORRECTLY AND WITH CARE FOR THE PURPOSE FOR WHICH IT IS INTENDED. FAILURE TO DO SO MAY CAUSE DAMAGE AND/OR PERSONAL INJURY AND WILL INVALIDATE THE WARRANTY. KEEP THESE INSTRUCTIONS SAFE FOR FUTURE USE.



Refer to Instruction
Manual

1. SAFETY

- ☐ **WARNING!** Use wheel storage rack on level and solid ground, preferably concrete. Ensure the floor over which the wheel storage rack will be transported is swept clean.
- ☐ **WARNING! DO NOT** use on tarmacadam or any other soft surface as the wheel storage rack may sink or topple.
- ☐ **WARNING! If a loaded wheel storage rack tips or leans STOP WHAT YOU ARE DOING. MOVE QUICKLY TO A SAFE DISTANCE. DO NOT TRY TO HOLD OR STEADY WHEEL STORAGE RACK.**
- ✓ Use wheel storage rack in a suitable work area, keep area clean and tidy and free from unrelated materials. Ensure there is adequate lighting.
- ✓ Before use, ensure that the size and weight of the wheels **DO NOT** exceed the capacity of the wheel storage rack.
- ✓ Maintain correct balance and footing when loading or moving the wheel storage rack. Ensure the floor is not slippery and wear non-slip footwear.
- ✓ Observe correct manual handling techniques when loading wheels on to the wheel storage rack. If in any doubt, obtain assistance.
- ✓ Apply castor wheel brakes when wheel storage rack is stationary.
- ☐ **WARNING! DO NOT** use wheel storage rack if any parts are damaged or missing.
- ✗ **DO NOT** allow untrained persons to use the wheel storage rack.
- ✗ **DO NOT** get wheel storage rack wet or use in damp or wet locations or areas where there is condensation.
- ✗ **DO NOT** use the wheel storage rack when you are tired or under the influence of alcohol, drugs or intoxicating medication.
- ✗ **DO NOT** use wheel storage rack for any purpose other than that for which it is designed.
- ✓ Before storing in safe area, ensure all parts are clean, free of grease and oil.
- ☐ **WARNING: The warnings, cautions and instructions discussed in this instruction manual cannot cover all possible conditions and situations that may occur. It must be understood that common sense and caution are factors which cannot be built into this product, but must be applied by the operator.**

2. INTRODUCTION

Completely freestanding wheel storage trolley for all types of car wheels with rim size up to 225mm. Easy to assemble. The trolley has three wheels, one which features a lockable castor wheel and ergonomic handle for easy manoeuvring around the garage. Eliminates tyre distortion due to loss of tyre pressure. Supplied with rim protecting supports.

3. SPECIFICATION

Model No: **STR005.V2**
Overall Size (W x D x H): 680 x 750 x 1220mm
Wheel Capacity: 4
Maximum Rim Size: 225mm
Maximum Weight Capacity: 100kg (25kg per Level)

4. ASSEMBLY

4.1. Assemble as in fig. 1.

fig.1

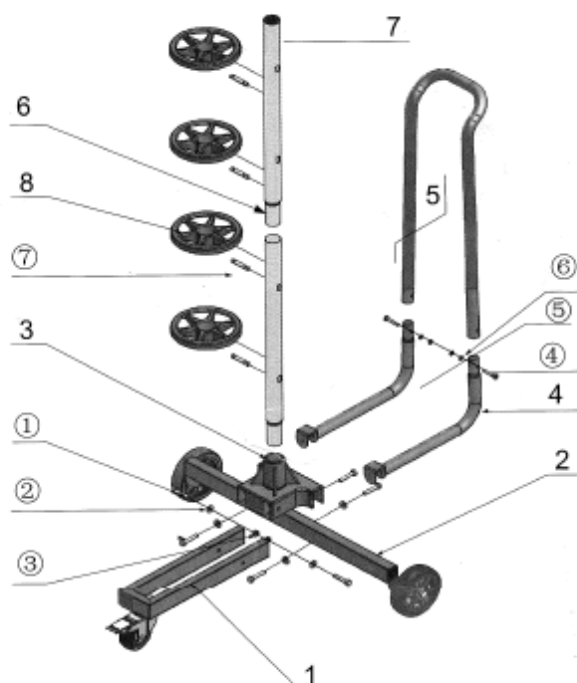

1	"U" Square tube	x1	①	M8x40mm bolt	x6
2	Square level	x1	②	M8 washer	x6
3	Plastic base	x1	③	M8 Nut	x2
4	Bent tube	x2	④	M6x35mm Round bolt	x2
5	"U" Round tube	x1	⑤	M6 Washer	x2
6	Aluminium tube	x1	⑥	M6 Nut	x2
7	Aluminium tube top	x1	⑦	Round bolt	x4
8	Plastic plate	x4			

5. OPERATION

- ❑ **WARNING!** If loading only one or two wheels **DO NOT** load them on the upper section. This will affect the stability of the trolley and may cause damage and/or injury.
- 5.1. Make sure path to the storage location is level, clear and free from debris.
- 5.2. Release brake on the castor (fig.2) and reapply the brake once the rack is in its desired location.
- 5.3. When not in use, store assembled in a safe, dry, childproof location.

6. MAINTENANCE

- 6.1. Keep the trolley clean.
- 6.2. Oil the wheels periodically.

fig.2

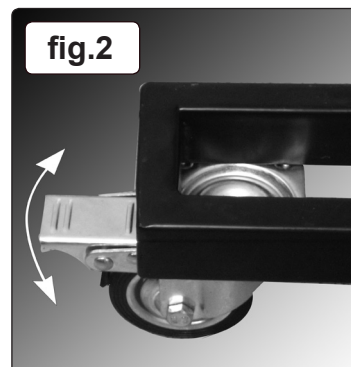

Parts support is available for this product. To obtain a parts listing and/or diagram, please log on to www.sealey.co.uk, email sales@sealey.co.uk or telephone 01284 757500.

Environmental Protection



Recycle unwanted materials instead of disposing of them as waste. All tools, accessories and packaging should be sorted, taken to a recycling centre and disposed of in a manner which is compatible with the environment. When the product becomes completely unserviceable and requires disposal of it according to local regulations.

NOTE: It is our policy to improve products continually and as such we reserve the right to alter data, specifications and component parts without prior notice.

IMPORTANT: No liability is accepted for incorrect use of this product.

WARRANTY: Guarantee is 12 months from purchase date, proof of which will be required for any claim.



Sole UK Distributor, Sealey Group,
Kempson Way, Suffolk Business Park,
Bury St. Edmunds, Suffolk,
IP32 7AR



01284 757500



01284 703534



www.sealey.co.uk



sales@sealey.co.uk