

baridi

Sliding Triple Door, Back Bar Drinks Fridge/Cooler, 307L Capacity, 452 Cans – Black

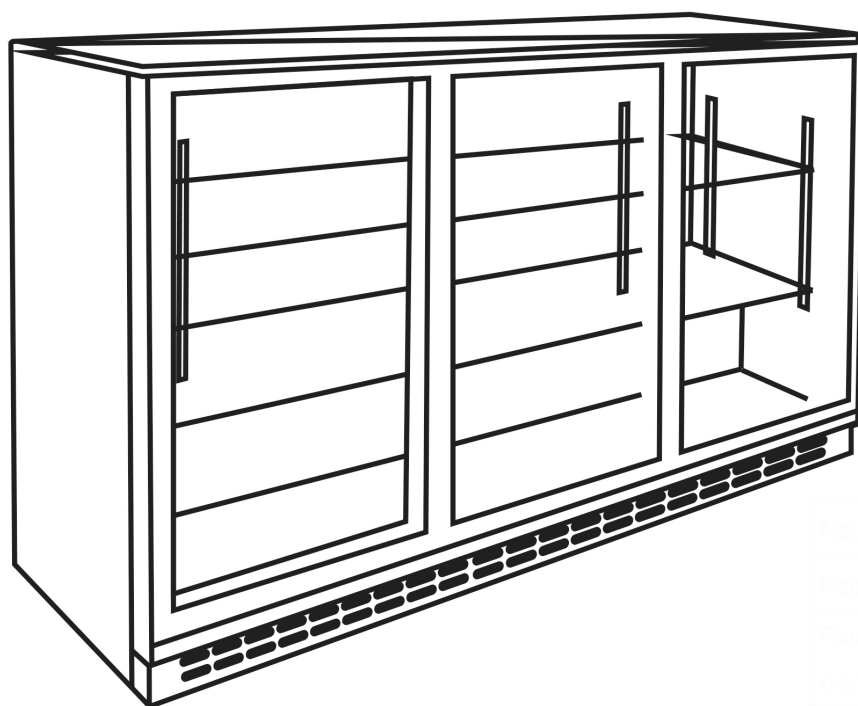

Model No: DH337

Thank you for purchasing a Baridi product from the Dellonda range. Manufactured to a high standard, this product will, if used according to these instructions, and properly maintained, give you years of trouble free performance.

Important Information

Please read these instructions carefully and note any safe operational requirements, warnings & cautions. Use the product correctly and with care for the purpose for which it is intended. Failure to do so may cause damage and/or personal injury and will invalidate the warranty. Keep these instructions safe for future use.



Refer to
instructions



Indoor use
only



WARNING!
flammable
material

SPECIFICATION

Model No	DH337	<p>* The climate class indicates the environment which the product has been tested.</p> <p>The product has been tested in the following conditions of (Dry Bulb Temperature °C / Relative Humidity % RH)</p> <p>0 = (20°C/50%RH) 1 = (16°C/80%RH) 2 = (22°C/65%RH) 3 = (25°C/60%RH) 4 = (30°C/55%RH) 6 = (27°C/70%RH)</p>
Capacity	307L or 452 x 330ml cans	
Climate Class*	0, 1, 2, 3, 4, 6	
Colour	Black	
Electrical Class	Class I	
Energy Rating:	C	
Foaming Gas	Cyclopentane	
Frequency	50Hz	
Fuse Rating:	13A	
Internal Dimensions (W x D x H):	1266 x 405 x 740mm	
IP Rating	IPX4	
Nett Weight:	70kg	
Noise Level:	45dB	
Power Cable Length	1.5m inc. Plug	
Plug Type	3-Pin BS	
Product Dimensions (W x D x H):	1350 x 512 x 870mm	
Rated Current	2.1A	
Refrigerant	R600a (75g)	
Temperature Range	0 - 10°C	
Voltage	220-240V	
Volume	312/307L (gross/nett)	
Maximum load per shelf	23kg	

SAFETY

ELECTRICAL SAFETY

- **WARNING!** It is the user's responsibility to check the following:
- Check all electrical equipment and appliances to ensure that they are safe before using.
- Inspect power supply leads, plugs and all electrical connections for wear and damage.
- Ensure that the insulation on all cables and on the appliance is safe before connecting it to the power supply.
- **DO NOT** use worn or damaged cables, plugs or connectors.
- Ensure that any faulty item is repaired or replaced immediately by a Baridi qualified technician.
- If the cable or plug is damaged during use, switch off the electricity supply and remove from use.
- Baridi recommend that an RCD (Residual Current Device) is used with all electrical products.
- **Important:** Ensure that the voltage rating on the appliance suits the mains power supply.
- **DO NOT** pull or carry the appliance by the power cable.
- **DO NOT** pull the plug from the socket by the cable.
- If the supply cord is damaged, it must be replaced by the manufacturer, its service agent or similarly qualified persons in order to avoid a hazard.
- Baridi recommend that an RCD (Residual Current Device) is used with all electrical products.
- **IMPORTANT:** Ensure that the voltage rating on the appliance suits the power supply to be used and that the plug is fitted with the correct fuse.
- **DO NOT** pull or carry the appliance by the power cable. **DO NOT** pull the plug from the socket by the cable.

GENERAL SAFETY

- Children shall **NOT** play with the appliance.
- Cleaning and user maintenance on the appliance shall not be made by children without supervision.
- **DO NOT** store explosive substances such as aerosol cans with a flammable propellant in this appliance.
- The appliance shall be disconnected from its power source during service and when replacing parts.
- Before switching on your fridge for the first time, read the information in this user manual carefully.
- Please keep this booklet in a safe place for future reference. If you ever sell your fridge, hand this user manual to the new owner.
- The manufacturer does not accept responsibility for any damages that may arise due to non-observation of these instructions. The user is liable for any material damage or bodily injury (product liability) caused by using the refrigerator carelessly or failing to follow instructions.
- **DO NOT** use damaged appliances. If you are in any doubt, consult a qualified engineer.
- Connection and installation of your fridge are to be carried out in strict compliance with the relative instructions in this manual.
- For safety, the appliance must be properly earthed in accordance with specifications.
- **NOTE:** Under standard operating conditions, the controller turns off the compressor once the target setpoint is reached. The compressor will reactivate when the measured temperature rises 5 °C above the setpoint. As a result, the temperature displayed on the electronic controller will typically be slightly higher than the configured value. This behaviour is normal and by design.



INSTALLATION

- The refrigerant used in this appliance is flammable. **DO NOT** damage any parts of the appliance which carry refrigerant by piercing, perforating, crushing, twisting or scraping. If the refrigerant comes into contact with the eyes, it may cause serious eye injury.
- **WARNING!** Always remember to disconnect from mains supply before cleaning. Always check that the plug and cable are undamaged.
- All repairs must be carried out by qualified engineers. Inadequate repairs may be dangerous. Never try to repair the refrigerator yourself.
- Ensure your chosen location has a flat and stable surface. The unit may be levelled by turning both of the stabilisers in the front corners. Check the unit is level using a spirit level. For stability, please ensure stabilisers are fully wound to floor.
- **WARNING!** Keep clear of obstruction all ventilation openings in the appliance enclosure or the structure for building in.
- **DO NOT** position this appliance with its rear panel directly against a wall. Maintain a gap of at least 50mm between the appliance and any adjacent wall.
- Position the fridge away from heat sources, where the units is well ventilated and protected from moisture, or extremes of heat or cold. The fridge may not function properly if the temperature rises above +30°C.
- Ensure all vents are clear of obstruction.
- Ensure there is a properly grounded power outlet available to safely operate the refrigerator.
- **WARNING! DO NOT** store explosive substances such as aerosol cans with a flammable propellant in this appliance.
- **WARNING! DO NOT** use mechanical devices or other means to accelerate the defrosting process, other than those recommended by the manufacturer.
- **WARNING! DO NOT** use electrical appliances inside the food storage compartments of the appliance, unless they are of the type recommended by the manufacturer.
- Electrical equipment should not be placed under the unit or where refrigerant could gather in the event of a leak.
- This refrigerating appliance is not intended to be used as a built-in appliance.

OPERATION

BEFORE FIRST USE

IMPORTANT! ALLOW THE REFRIGERATOR TO STAND UPRIGHT FOR 24 HOURS BEFORE CONNECTING TO MAINS SUPPLY.

- Remove all packaging and place the fridge on a stable, secure flat surface. Position the fridge away from heat sources, where the unit is well-ventilated and protected from moisture, or extremes of heat or cold. The fridge may not function properly if the temperature rises above +30°C.
- **NEVER USE AN EXTENSION LEAD:** If the mains cable will not reach the nearest socket, either rearrange your layout or ask a qualified electrician to fit a new socket.
- If power is cut off, wait for at least 5 minutes before plugging the unit in again to avoid damaging the compressor.
- **DO NOT** place combustible, explosive or volatile articles, corrosive acid or alkali, or liquid in glass containers into the fridge.
- **NOTE:** It is not recommended to operate the fridge on settings that run below 4°C/MAX. Such settings will cause content at the rear of the fridge close to evaporator to freeze, and will result in unnecessary strain on the cooling systems, and undue high energy consumption.

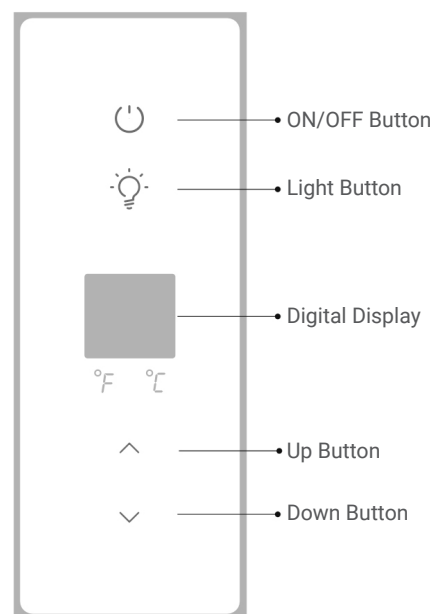

OPERATION

- Place the shelves on their supports.
- Check the fridge is working properly before installing and filling it.
- Never put warm or hot foods directly into the fridge.

ELECTRONIC THERMOSTAT

- The digital display will show the internal cabinet temperature. **NOTE:** This may fluctuate as the refrigerator cycles on/off this is not a fault.
- When the refrigerator is in cooling mode the light under the cooling symbol will illuminate.
- When the refrigerator cycles off the light will not be illuminated.
- 1. To turn on press the ON/OFF button.
- 2. To turn off press and hold the ON/OFF button for 6 seconds the display will disappear.
- **NOTE:** If the unit is unplugged, turned off or power is lost you must wait 3 to 5 minutes before restarting the unit.
- If you attempt to restart without waiting, the refrigerator will not start and may damage the compressor.

MAINTENANCE

- **WARNING!** Disconnect the mains power supply before carrying out any maintenance. All servicing must be performed by a qualified technician.

DEFROSTING

- Ice may build up on the evaporator if the unit is put to work constantly for a period of time.
- When ice begins to build up to approx 10 mm or 1/5 inch thick, defrost is required.
- Switch the thermostat to 'OFF' position.
- The ice will start to melt. When the ice has melted and drained away, dry off any residual moisture with a soft cloth.
- Switch on the power again via thermostat.

Please note it will take around 12 hours for the fridge and contents to get back down to temperature.

DOOR REMOVAL

- When cleaning the appliance or replacing the lamp it may be necessary to remove the doors to improve access.

Removing the Doors:

1. Lift the Door:

Holding both sides of the first door, lift it upward into the upper runner.

2. Disengage the Bottom:

While lifting, pull the bottom of the door outward and downward simultaneously so that it clears the bottom runner.

NOTE: The automatic door-closing system uses a spring to attach the doors to the appliance. Do not remove or damage the spring.

3. Set Aside the Door:

Carefully place the door to the side of the appliance.

4. Repeat:

Repeat the process for the remaining door.

Replacing the Doors

1. Insert into Upper Runner:

Lift the door and slot it into the upper runner.

2. Secure the Bottom:

Push the bottom of the door inward and downward to engage it with the bottom runner.

3. Check Alignment:

Ensure the door moves smoothly and closes automatically.

CLEANING

- UNPLUG your fridge and remove any stock to a suitable back-up fridge.
- Wash the inner compartment with warm water and neutral detergent. **DO NOT** allow the control panel, cables or plug to get wet. **NEVER** use corrosive detergents, wire brushes, or abrasive scourers to clean your chiller.
- **NEVER** use metal or sharp implements to remove debris.
- Dry all surfaces thoroughly.
- To ensure trouble-free operation the condenser should be cleaned every three months where appropriate using a vacuum cleaner. The condenser is located behind lower grill of the cabinet. In exceptionally dusty locations the condenser should be cleaned more often.
- Use mild soapy water to clean the gasket and seals.

REPLACING LIGHT STRIP

WARNING! Disconnect from mains supply.

- Remove the screws on both ends of the light. Gently pull down the light. Carefully remove the wires.
- Connect the wires and install the new light, replace the screws to fix in position. Initial Safety Measures.

ACCIDENT/BREAKDOWN

- Power Off Immediately: If there is smoke, sparks, or unusual noise, switch off the refrigerator at the mains.
- Evacuate if necessary: In case of fire or refrigerant leak, evacuate the area and ventilate.
- Avoid Contact: **DO NOT** touch leaking fluids or exposed electrical components.
- Refrigerant Leak Protocol.
- Ventilate the Area: Open windows and doors to disperse any leaked gases.
- **DO NOT** Use Open Flames: Avoid smoking or using electrical switches near the leak.
- Report the Incident: Notify maintenance or emergency services if the leak is significant.
- Electrical Failure or Short Circuit.
- Disconnect Power: Unplug the unit or turn off the circuit breaker.
- Inspect for Damage: Look for burnt wires, melted insulation, or tripped breakers.
- **DO NOT** Attempt Repairs: Only qualified personnel should handle electrical faults.
- **Mechanical Breakdown**
- Check for Obstructions: Ensure fans, motors, and compressors are not blocked.
- Listen for Unusual Sounds: Grinding or knocking may indicate internal damage.
- Record the Issue: Note the time, symptoms, and any error codes displayed.
- Food Safety Considerations.
- Monitor Temperature: Use a thermometer to check internal temperature.
- Notify Baridi stockist or repair centre the issue with full details.

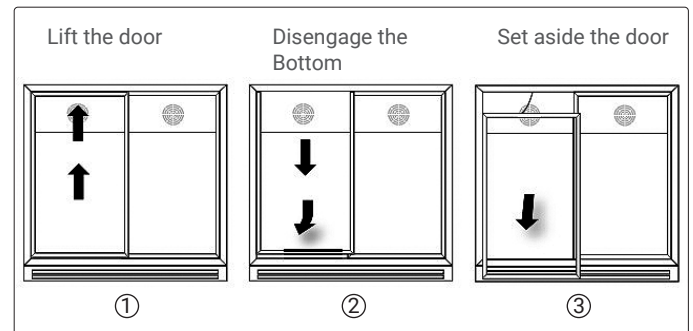

- Transfer Perishables: Move food to an alternative cold storage if safe to do so.
- Discard Unsafe Items: If food has been above 5°C (41°F) for more than 2 hours, dispose of it.
- Reporting and Documentation.

STORAGE

- Store upright in a dry, child free place, out of direct sunlight.

TRANSPORT

- Follow directions on carton. **DO NOT** clamp on the front or sides.

END OF LIFE

- When the triple-door drinks fridge reaches the end of its service life, the doors must be removed and the unit disposed of in accordance with applicable environmental regulations.



Environment Protection, Waste Electrical and Waste Electronic Equipment Regulations (WEEE)

Recycle unwanted packaging materials. When this product is no longer required, or has reached the end of its useful life, please dispose of in an environmentally friendly way. Drain any fluids (if applicable) into approved containers, in accordance with local waste regulations. It is our policy to continually improve products and we reserve the right to alter data, specifications and parts without prior notice. No liability is accepted for incorrect use of this product. Guarantee is 12 months from purchase date, proof of which is required for any claim.

Jack Sealey Ltd t/a Baridi, Kempson Way, Suffolk Business Park, Bury St Edmunds, Suffolk, IP32 7AR UK
Jack Sealey (EU) Ltd t/a Baridi, Farney Street, Carrickmacross, Co. Monaghan, A81 PK68 Ireland
Tel: 01284 757575 • **Email:** support@baridi.co.uk • **Web:** www.baridi.co.uk