

SEALEY

CEMENT MIXER WITH STAND

MODEL NO'S: **CMX135 550W 135L/**
CMX160 550W 160L

Thank you for purchasing a Sealey product. Manufactured to a high standard, this product will, if used according to these instructions, and properly maintained, give you years of trouble free performance.

IMPORTANT: PLEASE READ THESE INSTRUCTIONS CAREFULLY. NOTE THE SAFE OPERATIONAL REQUIREMENTS, WARNINGS & CAUTIONS. USE THE PRODUCT CORRECTLY AND WITH CARE FOR THE PURPOSE FOR WHICH IT IS INTENDED. FAILURE TO DO SO MAY CAUSE DAMAGE AND/OR PERSONAL INJURY AND WILL INVALIDATE THE WARRANTY. KEEP THESE INSTRUCTIONS SAFE FOR FUTURE USE.

Wear a mask according to the materials being mixed



Wear protective gloves



Refer to instruction manual



Wear safety footwear



Wear safety glasses



Keep people away



Remove from mains: during cleaning & maintenance

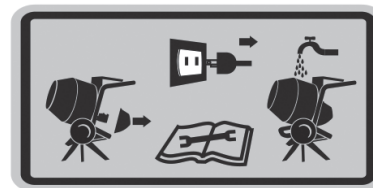

Keep hands and tools away from moving parts



Protect environment



Use on level ground



Keep area clear for operation and tipping



DO NOT plug into mains with cover off

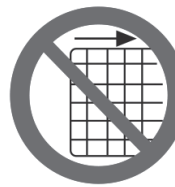

Keep guards in place

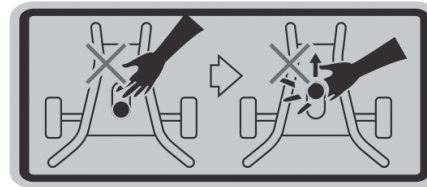

DO NOT pass hand through clearance between frame and support leg or between drum and support leg

1. SAFETY

1.1. ELECTRICAL SAFETY

- ❑ **WARNING!** It is the user's responsibility to check the following:
 - Check all electrical equipment and appliances to ensure that they are safe before using.
 - Inspect power supply leads, plugs and all electrical connections for wear and damage.
 - Ensure that the insulation on all cables and on the appliance is safe before connecting it to the power supply.
- ✗ **DO NOT** use worn or damaged cables, plugs or connectors.
- ✓ Ensure that any faulty item is repaired or is replaced immediately by a qualified electrician.
- ✓ If the cable or plug is damaged during use, switch off the electricity supply and remove from use.
- ✓ **Ensure that repairs are carried out by a qualified electrician.**
- ✓ Sealey recommend that an RCD (Residual Current Device) is used with all electrical products.
- ✓ **Important:** Ensure that the voltage rating on the appliance suits the power supply to be used and that the plug is fitted with the correct fuse.



WARNING!
Electricity

- ✗ **DO NOT** pull or carry the appliance by the power cable.
- ✗ **DO NOT** pull the plug from the socket by the cable.
- 1.1.1. Avoid Electric Shock:
 - ✓ Check that the electric circuit is adequately protected and that it corresponds with the power, voltage and frequency of the motor.
 - ✗ **DO NOT** plug or unplug the motor while standing in or around damp or wet ground. **DO NOT** use the mixer in wet or damp areas or expose it to rain.
 - ✓ Prevent body contact with grounded surfaces: pipes, radiators, ranges, and refrigerator enclosures.
 - ✓ After installation, the degree of protection of the BSI approved plug and socket combination shall be IP44D at least.
 - ✓ Extension cords must be no longer than 50 meters in length. The wire section must be 1.5mm² on 230V to allow sufficient current flow to the motor. Improper use of extension cords may cause inefficient operation of the mixer which can result in overheating and motor damage.

1.2. GENERAL SAFETY

- ✓ Trained users only to use this product.
- 1.2.1. **UNDERSTAND THE PRODUCT:**
 - ✓ Read and understand the owner's manual and labels affixed to the mixer.
 - ✓ Learn its application and limitations as well as the specific potential hazards peculiar to it.
 - ✓ Become familiar with the controls before operating this mixer.
- 1.2.2. **STAY ALERT:**
 - ✗ **DO NOT** operate the mixer while under the influence of drugs, alcohol, or any medication that could affect your ability to use it properly.

- ✗ **DO NOT** use this mixer when you are tired or distracted from the job at hand. Watch what you are doing at all times. Use common sense.
- 1.2.3. **AVOID DANGEROUS SITUATIONS:**
 - ✓ Make sure there is adequate surrounding workspace.
 - ✓ Keep your work area clean and well lit. Cluttered areas invite injuries. Keep area around the mixer clear of obstructions, grease, oil, trash and other debris which could cause persons to fall onto moving parts.
 - ✓ Only use or operate the mixer on solid, flat, level ground that is capable to support the weight of the mixer and its load to prevent the mixer from tipping over.
 - ✗ **DO NOT** attempt to move the mixer when it is loaded and/or in operation.
 - ✓ This mixer is intended for the production of concrete, mortar and plaster. It is not suitable for the mixing of flammable or explosive substances.
 - ✗ **DO NOT** use it in areas where fumes from paint, solvents or flammable liquids pose a potential hazard.
- 1.2.4. **INSPECT YOUR MIXER:**
 - ✗ Check your mixer before turning it on. Keep guards in place and in working order. **DO NOT** plug into mains supply with motor cover open.
 - ✓ Check all bolts, nuts, and screws for tightness before each use, especially those securing guards and drive mechanisms. Vibration during mixing may cause these to loosen.
 - ✓ Form a habit of checking to see that all tools, shovels, hand trowels and other tools/equipments are removed from mixer area before turning it on.
 - ✓ Replace damaged, missing or failed parts before using it.
 - ✓ Warning labels carry important information. Replace any missing or damaged warning labels.
- 1.2.5. **DRESS PROPERLY:**
 - ✗ **DO NOT** wear loose clothing, gloves, neck ties or jewellery (rings, wrist watches). They can be caught in moving parts.
 - ✓ Protective electrically non-conductive gloves and non-skid footwear are recommended when working. Wear protective hair covering to contain long hair, preventing it from getting caught in machinery.
 - ✓ Wear a face or dust mask if the operation is dusty. Be aware of the safety advice for working with cement. Refer to manufacturer's advice on the product, that is being used.
 - ✓ Always wear safety goggles and/or face shields. Everyday eyeglasses have only impact resistant lenses. They are not safety glasses.
- 1.2.6. Keep people away:
 - ✓ Keep unauthorized persons away from the mixer.
 - ✗ **DO NOT** allow children to handle or climb on or in the mixer.
- 1.2.7. **DO NOT OVERREACH:**
 - ✓ Keep proper footing and balance at all times when loading or unloading the mixer.
 - ✗ Never stand on mixer. Serious injury could occur if the mixer is tipped or if the moving parts are unintentionally contacted.
 - ✗ **DO NOT** store anything above or near the mixer where anyone might stand on the mixer to reach them.
- 1.2.8. **AVOID INJURY FROM UNEXPECTED ACCIDENTS:**
 - ✓ Keep hands out of the way of all moving parts. **DO NOT** place any part of your body or any tool, like shovel in the drum during operation. When operating, **DO NOT** pass hands through the clearance between frame and support leg or the one between the drum and support leg.
- 1.2.9. **DO NOT FORCE TOOL:**
 - ✓ It will do a better and safer job at its designed rate. Always work within the rated capacity.
 - ✗ **DO NOT** start the motor if the drum is fully loaded. **DO NOT** turn mixer off while full of concrete.
 - ✗ **DO NOT** use the mixer for a purpose for which it was not intended.
 - ✗ The mixer is not to be towed by any vehicle.
- 1.2.10. **NEVER LEAVE MIXER RUNNING UNATTENDED:**
 - ✗ **DO NOT** leave mixer until it has come to a complete stop.
- 1.2.11. **DISCONNECT POWER:**
 - ✗ Never open the motor cover before unplugging the mixer.
 - ✓ Disconnect from power supply when not in use, before moving, making adjustments, changing parts, cleaning, or working on the mixer.
 - ✓ Consult technical manual before servicing.
- 1.2.12. **MAINTAIN YOUR MIXER WITH CARE:**
 - ✓ Clean the mixer immediately after use. Keep the mixer clean for best and safest performance.
 - ✓ When maintaining this mixer, only the manufacturer's original replacement parts may be used.
- 1.2.13. **PROTECT THE ENVIRONMENT:**
 - ✓ Take left over materials to an authorized collection point or follow the stipulations in the country where the mixer is used.
 - ✗ **DO NOT** discharge into drains, soil or water.
- 1.2.14. **STORE IDLE EQUIPMENT:**
 - ✓ When not in use, the mixer should be stored in a dry location to inhibit rust. Keep the mixer away from children and others not qualified to use it.
- 1.2.15. **FIRE FIGHTING:** Refer to MSDS.
 - ✗ **DO NOT** to reach into the drum interior to the rotating blades.

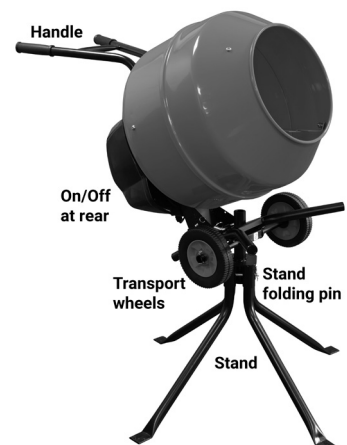

2. INTRODUCTION

Powerful 550W insulated motor for continuous mixing. 125/135L drum with 79/100L mixing capacity. Easily attach or remove legs for storage or transportation. Large Ø200mm wheels for easy portability.

3. FEATURES

See diagram on right.

4. SPECIFICATION

Model No: CMX135/160
 Drum Capacity: 135L/160L
 IP Rating: IP44D/
 Mixing Capacity: 100L/115L
 Drum Speed: 25/26rpm
 Drum Opening: 385mm
 Motor Power: 550W
 Noise Level Empty: 93dB/
 Weight: 48kg/52kg
 Plug Type: 3-Pin
 Power Supply: 230V 50Hz

Permissible Environmental Conditions: -40° to 40°C
 Short Circuit Rating for Incoming Power Supply: 9.6A
 Full-Load Current Rating for Incoming Power Supply: 2.4A
 Duty Cycle: S6 30%
 Electrical Class: Class II

5. CONTENTS

Refer to Parts List for descriptions.

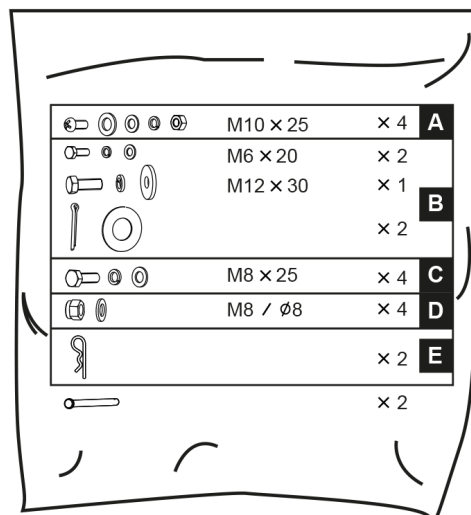
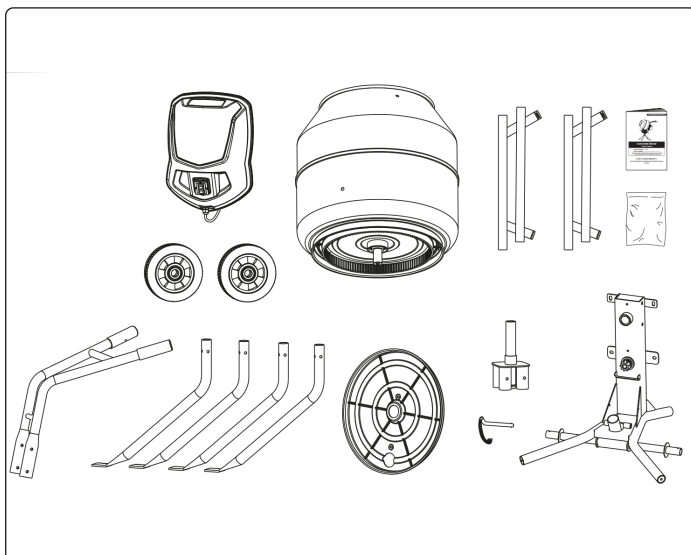

Fixings: Letters refer to specific Assembly Operations.

6. ASSEMBLY

NOTE: Two persons required to Assemble.

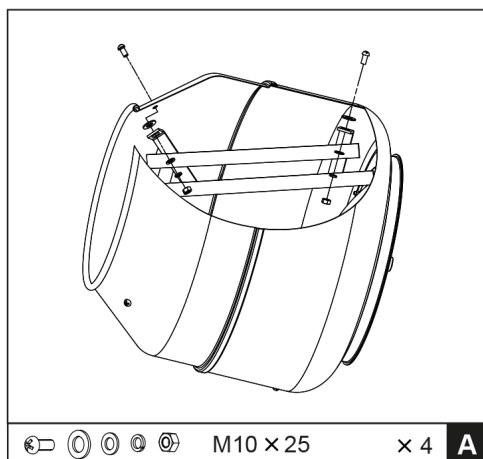

A: Insert the cross headed screws from the outside through the holes in the drum.

Place a plastic washer inside between the drum and blade and secure the mixing blade from the inside using a flat washer, lock washer and nut.

B: (i) Rotate the chain end ring into one hole in the triangle support.

Then insert the pin rod into the two tubes in order from the same side of the hole that connects chain to the opposite.

(ii) Slide the wheels over the stub axles. Secure each wheel with a flat washer and hairpin retainer.

(iii) Lining up the holes in the plastic bottom plate with the ones in the frame. Secure the plate on the frame with two M6x20 bolts each with a lock washer and flat washer.

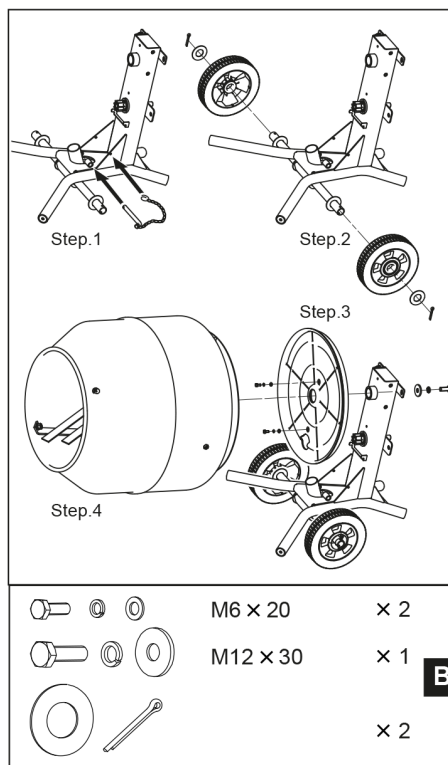

(iv) Position the drum onto the plastic bottom plate as shown. Hold it in place and secure it with a M12x30 bolt with lock washer and flat washer.

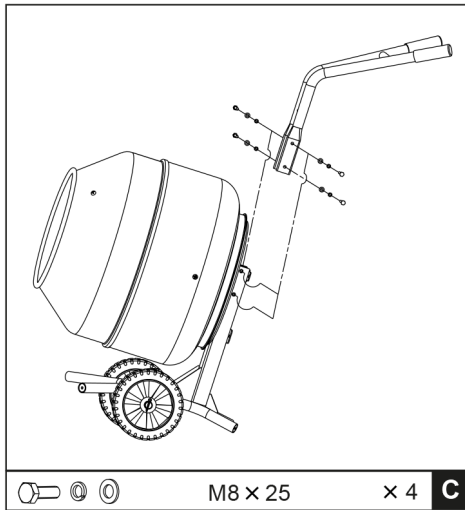

C: Lining up the holes in the handle bar with the ones in the support frame. Secure them together with bolts, lock washers and flat washers.

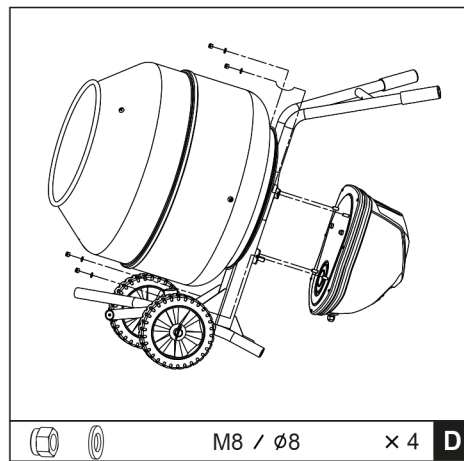

D: Lining up the keyways, slide the transmission case over the pinion shaft. Secure a nut with flat washer on each of the four stub bolts.

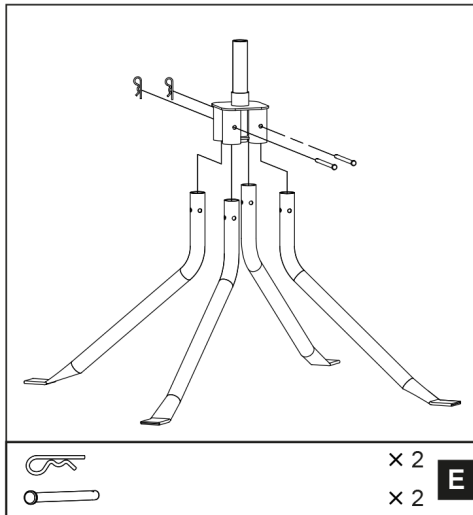

E: Insert the support legs into the bracket and secure them together with shaft and hairpin.

7. OPERATION

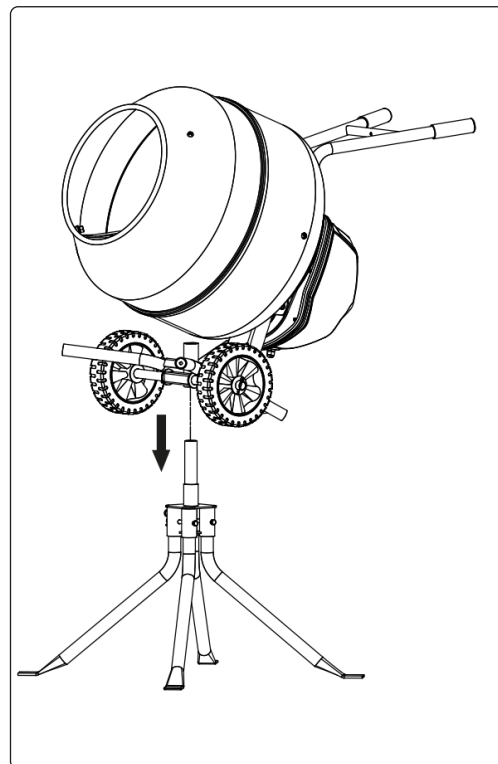
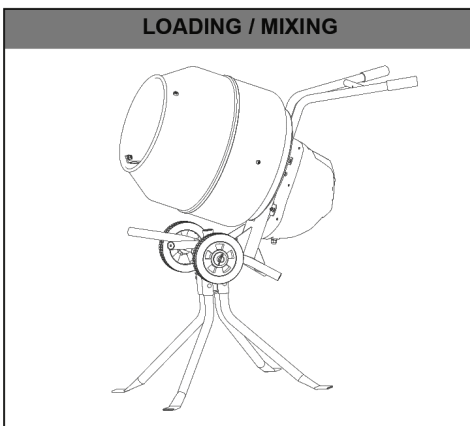

Place support stand into the whole in the axle bracket as shown.



WARNING! DO NOT operate with the motor cover open.

7.1. Check that mixer is standing securely and that there is enough area around it to work safely.

7.2. Connect to mains supply.

7.3. Switch mixer on (switch is located on side of motor cover).

7.4. **LOADING**

Completely unwind the extension cord. Connect it to the concrete mixer first before plugging into the mains power supply.

Always start the mixer before loading the drum. Loading the drum with drum rotating.

✗ **DO NOT** throw material into the mixer to avoid sticking firmly to the back of the drum. Trickle it steadily over the rim.

NOTE: A built-in thermal protector is arranged in the motor to prevent it from overheating. The thermal protector restores automatically when the motor cools down.

For best results, proceed as follows:

A: Add the required amount of gravel into the drum.

B: Add the required amount of cement into the drum.

C: Add the required amount of sand into the drum.

D: Add the required amount of water into the drum.

7.5. EMPTYING

DO NOT turn mixer off while full of load. Emptying the drum with drum rotating.

7.6. IN EVENT OF BREAKDOWN /EMERGENCY STOP:

Switch mixer off (if it is safe to do so) or if not disconnect from mains supply.

Investigate fault.

7.7. CLEANING

Thoroughly clean the mixer at the end of each day's operation. Keep your mixer clean. The slightest trace of material left in the drum will harden and attract more each time you use it until the machine is useless. Dried cement should be scraped out of the drum.

× **DO NOT** throw bricks into mixer drum to clean it out.

× **DO NOT** beat on the drum with a shovel, a hammer or other tools to break up accumulations of dried cement mix, as damage to the mixer may result.

× **DO NOT** pour or spray water directly over the motor cover, especially the openings in it.

7.8. Wipe off any external material on the motor. **DO NOT** use petrol, turpentine, lacquer or paint thinner, dry cleaning fluids or any such solvents.

7.9. TRANSPORT

7.9.1. Secure whilst transporting to prevent damage.

7.9.2. Unload on wheels down a ramp **DO NOT** allow to fall from a vehicle.

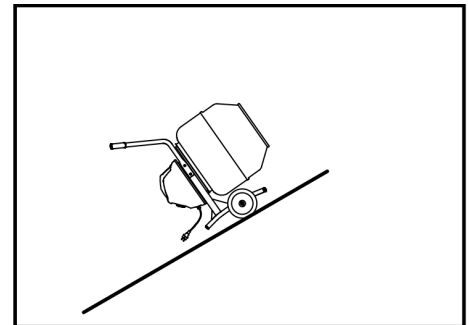
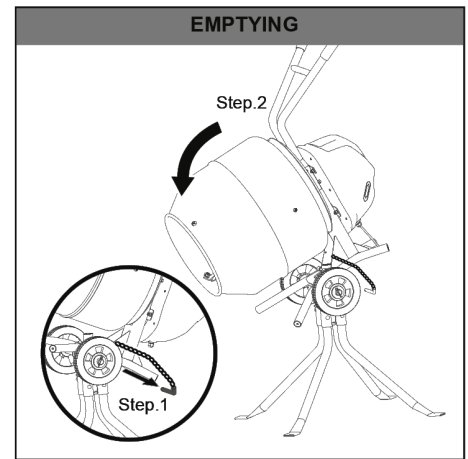

8. MAINTENANCE

☐ **WARNING!** Before starting any maintenance or repairs, stop engine or switch off motor, and isolate from the mains supply.

☐ **WARNING!** Never put hands inside the drum with drum rotating.

On completion of maintenance, check that the mixer functions correctly and that all guard are correctly fitted

9. END OF LIFE

9.1. Dismantle mixer (perform reverse of assembly section). Recycle according to regulations in force.



WEEE REGULATIONS

Dispose of this product at the end of its working life in compliance with the EU Directive on Waste Electrical and Electronic Equipment (WEEE). When the product is no longer required, it must be disposed of in an environmentally protective way. Contact your local solid waste authority for recycling information.



ENVIRONMENT PROTECTION

Recycle unwanted materials instead of disposing of them as waste. All tools, accessories and packaging should be sorted, taken to a recycling centre and disposed of in a manner which is compatible with the environment. When the product becomes completely unserviceable and requires disposal, drain any fluids (if applicable) into approved containers and dispose of the product and fluids according to local regulations.

Note: It is our policy to continually improve products and as such we reserve the right to alter data, specifications and component parts without prior notice.

Important: No Liability is accepted for incorrect use of this product. Warranty: Guarantee is 12 months from purchase date, proof of which is required for any claim.

Jack Sealey Ltd t/a Sealey Group, Kempson Way, Suffolk Business Park, Bury St Edmunds, Suffolk, IP32 7AR UK

Jack Sealey (EU) Ltd t/a Sealey Group, Farney Street, Carrickmacross, Co. Monaghan, A81 PK68 Ireland

Tel: 01284 757500 • Email: sales@sealey.co.uk • Web: www.sealey.co.uk



REGISTER YOUR PURCHASE HERE