

Operation mode

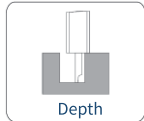

Steps



Depth

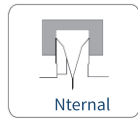

Internal

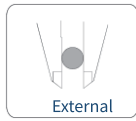

External

1. Use steps

1. Rotate to right to loosen the locking screw of the caliper and release the lock of the caliper, then hand-pushed roller caliper can be moved
2. Turn on to check if the caliper display and keys work.
3. Clean the measuring surfaces of the measuring tool. Close the measuring claw with appropriate force, shortly-press $\phi/0$ to turn on and set

2. Measurement operation

- Press the switch or pull the caliper frame to light up the display.
- According to the measurement requirements, press the Metric/inch button to select the measurement unit.
- Move the caliper frame so that the measuring surfaces of the two calipers are in close contact with the surfaces of the measured object, and then read the value shows on screen.

Normal mode : Turn on the power supply, the display shows the position of the ruler frame before turning off the power supply, and the zero position (origin) of the caliper is the last set zero position (origin) before power supply. When using the absolute measurement mode, there is no need to adjust the origin position. When using the relative measurement mode, Press INC to adjust the zero position (non origin) according to the demand.

Power saving mode (shutdown time is more than 8 hours): turn on the power supply, and the absolute measurement zero position (origin) of the caliper is the position of the caliper frame when starting up. After the measuring surface needs to be cleaned, move the ruler frame to close the measuring surface, and long press the $\phi/0$ key for five seconds to reset the zero position (origin) of the absolute measurement mode.

d. Switching between absolute measurement and relative measurement

Relative measurement: briefly press the INC button, the Inc indicator appears in the left corner of the LCD display, and the caliper enters the Inc memory measurement. At the same time, clear to zero, and start counting from the position of the caliper frame to zero when pressing the INC key.

Absolute measurement: press the INC button in the relative measurement mode, the Inc indicator will disappear and return to the absolute mode, and the counting will start from the zero position (origin) set by the startup.

Cleaning and maintenance

1. After use, wipe the oil-water stains and dirt on the product surface with a clean dust-free cloth to avoid the corrosion of the product surface caused by dirt. Minimize the use of cleaning solvents. If necessary, WD40 solvent and anhydrous alcohol solvent can be used. Wipe the alcohol immediately after cleaning the dirt.
2. After use, please put the caliper on the protective sleeve in time and put it into the caliper box to avoid damage caused by falling and collision.

Replace and set the battery origin

1. The flashing number on the LCD display indicates that the battery is low. Remove the battery box and replace it with the same battery (positive side up).
2. Move the slider and close the jaw, press and hold the 0 button for about 5 seconds, and "0.00" is displayed, indicating that the origin (absolute zero) setting is completed.

Warning: follow the following safety instructions

- Do not short circuit the battery.
- Do not put the battery near iron or heat source, or use it in direct sunlight.
- When the battery is stored for a long time, it will not leak.
- Do not use batteries with liquid leakage and do not disassemble batteries.

Product features

1. Set zero at any position.
2. The measurement unit can be set to mm/in/F.
3. Can maintain the consistency of the origin.
4. Whenever it is turned on, the LCD will display the current ruler frame position at any time
5. The absolute origin is adopted, and there is no need to adjust the zero position repeatedly.
6. Minute automatic screen shutdown, 8-hour automatic power failure, low power consumption design
7. No response speed limit, no error due to average speed change

Product Figure and Buttons

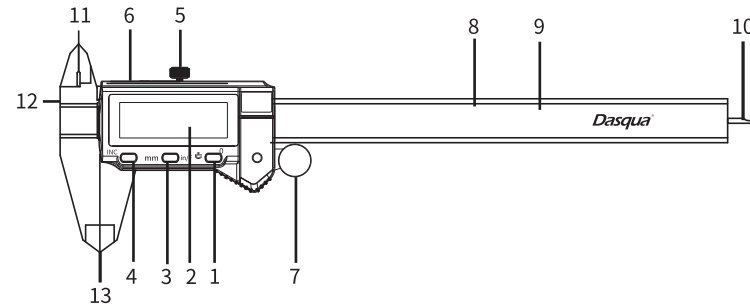

1. $\phi/0$ button: Press and release Power on/off, System will work under absolute measuring mode when power on.
2. LCD screen: display measurement value.
3. INC button: Press and release the button at any position. LCD will display "0.00" and "INC", the caliper is ready for relative measurement. Press and can turn back the absolute measurement. This time the symbol "INC" disappear.
4. mm/in/F button: Press this button can change measuring standard.
5. Locking screw: Left twist for fixing caliper position, right twist for unlock.
6. Battery cover: replace battery.
7. Thumb roller: used to push measurement.
8. Scale
9. Beam
10. Depth measurement rod: measuring depth.
11. Internal jaws: measuring Internal dimension.
12. Step measurement: measuring step dimension.
13. External jaw: measuring external dimension.

Parameter

Measuring range	0-150mm (0-6")/0-200mm(0-8")/0-300mm(0-12")
Accuracy	0.01mm/0.0005" 1/128"
Power	CR2032 lithium battery
Environmental humidity	0-80%
Working temperature	0-40°C(32 -104°F)
Storage and transportation	-20~70°C(18-140°F)