



ALUMINIUM COMBINATION LADDER WITH TOOLBOX 3 X 5 - EN 131

MODEL NO: **ACL205**

Thank you for purchasing a Sealey product. Manufactured to a high standard, this product will, if used according to these instructions, and properly maintained, give you years of trouble free performance.

IMPORTANT: PLEASE READ THESE INSTRUCTIONS CAREFULLY. NOTE THE SAFE OPERATIONAL REQUIREMENTS, WARNINGS & CAUTIONS. USE THE PRODUCT CORRECTLY AND WITH CARE FOR THE PURPOSE FOR WHICH IT IS INTENDED. FAILURE TO DO SO MAY CAUSE DAMAGE AND/OR PERSONAL INJURY AND WILL INVALIDATE THE WARRANTY. KEEP THESE INSTRUCTIONS SAFE FOR FUTURE USE.

1. SAFETY SYMBOLS



WARNING! fall from the ladder.



DO NOT ascend or descend unless you are facing the ladder.



Refer to instruction manual/booklet.



Keep a secure grip on the ladder when ascending and descending. Maintain a handhold whilst working from a ladder or take additional safety precautions if you cannot.



Inspect the ladder after delivery. Before every use visually check the ladder is not damaged and is safe to use. **DO NOT** use a damaged ladder.



Avoid work that imposes a sideways load on ladders, such as side-on drilling through solid materials.



Maximum total load.



DO NOT carry equipment which is heavy or difficult to handle while using a ladder.



DO NOT use the ladder on a unlevel or unfirm base.

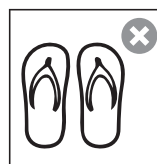

DO NOT wear unsuitable footwear when climbing a ladder.



DO NOT overreach.



DO NOT use the ladder if you are not fit enough. Certain medical conditions or medication, alcohol or drug abuse could make ladder use unsafe.

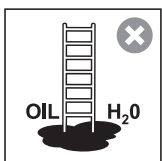

DO NOT erect ladder on contaminated ground.

- * **DO NOT** spend long periods on a ladder without regular breaks (tiredness is a risk).
- ✓ Prevent damage of the ladder when transporting e.g. by fastening and, ensure they are suitably placed to prevent damage.
- ✓ Ensure the ladder is suitable for the task.
- * **DO NOT** use the ladder if contaminated, e.g. with wet paint, mud, oil or snow.
- * **DO NOT** use the ladder outside in adverse weather conditions, such as strong wind.



Maximum number of users.

- ✓ For professional use a risk assessment shall be carried out respecting the legislation in the country of use.
- ✓ When positioning the ladder take into account risk of collision with the ladder e.g. from pedestrians, vehicles or doors. Secure doors (not fire exits) and windows where possible in the work area.



DO NOT lean the ladder against unsuitable surfaces.

- ✓ Ladder shall never be moved from the top.



DO NOT stand on the top three steps/rungs of a leaning ladder.



DO NOT step off the side of standing ladder onto another surface.

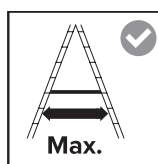

Open the ladder fully before use.



Standing ladders shall not be used as a leaning ladder unless it is designed to do so.



DO NOT stand on the top two steps/rungs of a standing ladder without a platform and a hand/knee rail.



Any horizontal surface which looks like a platform on a standing ladder that is not designed for standing on (e.g. a plastic work tray) shall be clearly indicated on that surface, (only if necessary due to design of ladder).

- ✓ Single or multiple joint ladders should be unfolded/folded when lying on the ground and not in its use position.

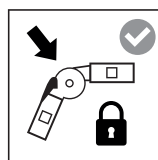

Ensure that the hinges are locked.



WARNING!
Electricity hazard

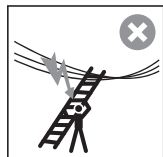

Identify any electrical risks in the work area, such as overhead lines or other exposed electrical equipment and do not use the ladder where electrical risks occur.

- ✓ Use non-conductive ladders for unavoidable live electrical work.

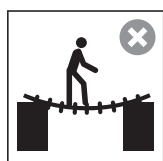

DO NOT use the ladder as a bridge.

- ✗ **DO NOT** modify the ladder design.
- ✗ **DO NOT** move a ladder while standing on it.
- ✓ For outdoor use caution to the wind.

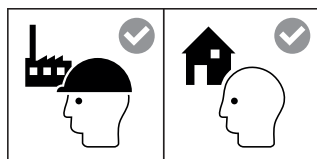

Ladder for professional use.



Leaning ladders with rungs shall be used at the correct angle.

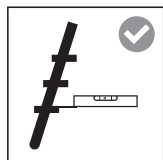

Leaning ladders with steps shall be used that the steps are in a horizontal position.

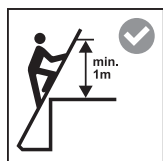

Ladders used for access to a higher level shall be extended at least 1 m above the landing point and secured, if necessary.

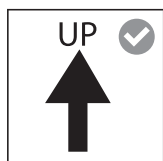

Only use the ladder in the direction as indicated, only if necessary due to design of ladder.

2. INTRODUCTION

Aluminium combination ladder manufactured to EN 131. Ideal for everyday tasks either as a stepladder or leaning ladder. Features toolbox for tool storage while on the job but can also be used as an extra step. Extends to 2.95m when used as a leaning ladder or 1.8m when used as a stepladder Easy to transport at just 9kg.

3. SPECIFICATION

Model No	ACL205
Maximum Extension	2.95m
Minimum Height	1.8m
Maximum Capacity	150kg
Nett Weight	9.2kg
Tread Count	3 x 5

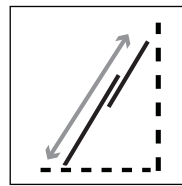

2.95 m

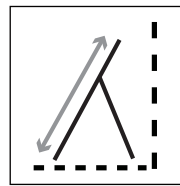

1.80 m

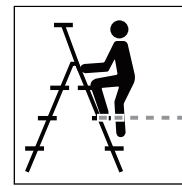

MAX. 0.86 m

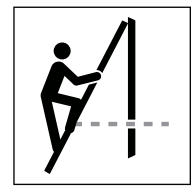

MAX. 1.71 m

4. OPERATION

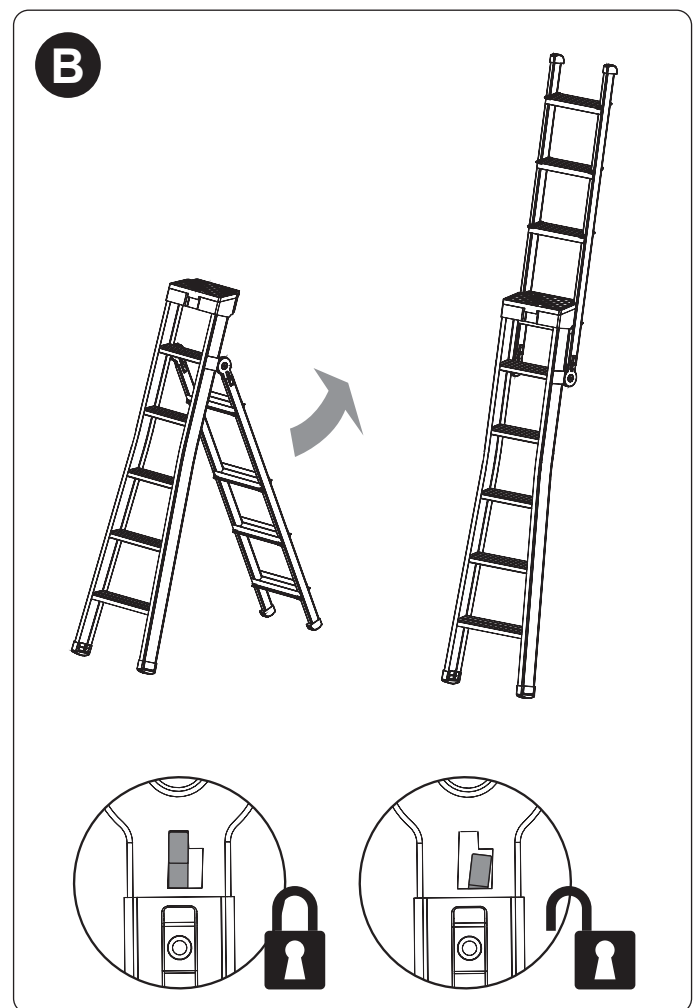
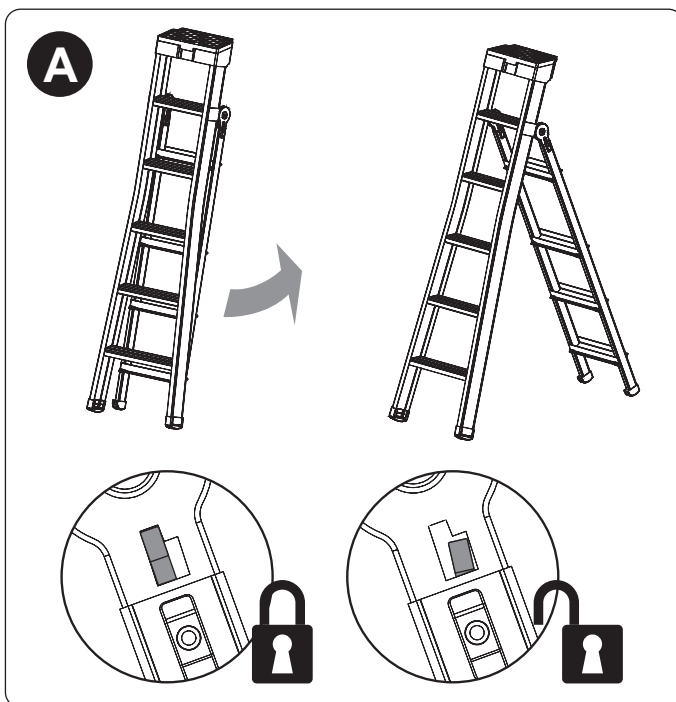
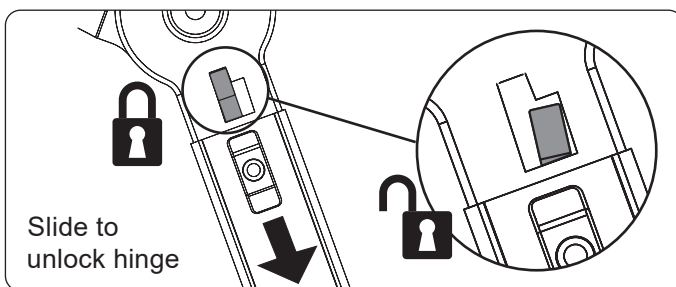

5. STORAGE

Ladders should be stored:

- ✓ Inside a dry, secure area, or under cover as a minimum.
- ✓ Away from damage by impact or chemicals.
- ✓ Away from the outside of houses.
- ✓ Out of the way of exits and walk-ways.
- ✓ Horizontally, ideally on their side to avoid a tripping hazard.



ENVIRONMENT PROTECTION

Recycle unwanted materials instead of disposing of them as waste. All tools, accessories and packaging should be sorted, taken to a recycling centre and disposed of in a manner which is compatible with the environment. When the product becomes completely unserviceable and requires disposal, drain any fluids (if applicable) into approved containers and dispose of the product and fluids according to local regulations.



REGISTER YOUR
PURCHASE HERE

Note: It is our policy to continually improve products and as such we reserve the right to alter data, specifications and component parts without prior notice. Please note that other versions of this product are available. If you require documentation for alternative versions, please email or call our technical team on technical@sealey.co.uk or 01284 757505.

Important: No Liability is accepted for incorrect use of this product.

Warranty: Guarantee is 12 months from purchase date, proof of which is required for any claim.

Jack Sealey Ltd t/a Sealey Group, Kempson Way, Suffolk Business Park, Bury St Edmunds, Suffolk, IP32 7AR UK
Jack Sealey (EU) Ltd t/a Sealey Group, Farney Street, Carrickmacross, Co. Monaghan, A81 PK68 Ireland
Tel: 01284 757500 - **Email:** sales@sealey.co.uk - **Web:** www.sealey.co.uk