



# SCISSOR JACK KIT FOR ELECTRIC VEHICLES HEAVY-DUTY 2 TONNE

MODEL NO: **59M**

Thank you for purchasing a Sealey product. Manufactured to a high standard, this product will, if used according to these instructions, and properly maintained, give you years of trouble free performance.

**IMPORTANT:** PLEASE READ THESE INSTRUCTIONS CAREFULLY. NOTE THE SAFE OPERATIONAL REQUIREMENTS, WARNINGS & CAUTIONS. USE THE PRODUCT CORRECTLY AND WITH CARE FOR THE PURPOSE FOR WHICH IT IS INTENDED. FAILURE TO DO SO MAY CAUSE DAMAGE AND/OR PERSONAL INJURY AND WILL INVALIDATE THE WARRANTY. KEEP THESE INSTRUCTIONS SAFE FOR FUTURE USE.



Refer to  
instructions



Wear safety  
footwear

## 1. SAFETY

- ✓ The user shall work only in accordance with this instruction manual.
- ✓ The operator shall be provided with all necessary information about training and about pumping and translating forces.
- ✓ Ensure the jack is in sound condition and good working order. Take action for immediate repair or replacement of damaged parts. Use genuine parts only. **DO NOT** modify the jack. The use of non-genuine parts may be dangerous and will invalidate the warranty.
- ✓ Locate the jack in a suitable, well lit working area.
- ✓ Keep working area clean and tidy and free from unrelated materials. Use jack on level and solid ground, preferably concrete. Avoid tarmac as jack may sink in.
- ✓ Chock wheels of vehicle.
- ✓ Ensure minimum distance of 0.5m between vehicle and static objects such as doors, walls, etc. to allow for vehicle tilting.
- ✓ Ensure all non-essential persons keep a safe distance whilst the jack is in use.
- ✓ Ensure there are no passengers in the vehicle.
- ✓ It is necessary that the operator can watch the lifting device and the load during all movements.
- ✓ Place jack under only those lifting points recommended by vehicle manufacturer (see vehicle handbook).
- ✓ Check that the lifting point is stable and centred on the jack saddle.
- ▲ **DANGER:** Use the jack for lifting only, NOT for supporting the lifted load.
- ✓ Ensure there are no persons or obstructions beneath the vehicle before lowering.
- ✓ It is not allowed to work under the raised load until it is secured by suitable means. Use suitable axle stands under the vehicle before proceeding with any task.
- ✓ Use a qualified person to lubricate and maintain the jack.
- ✗ **DO NOT** operate the jack if damaged.
- ✗ **DO NOT** allow untrained persons to operate the jack.
- ✗ **DO NOT** operate the jack when tired or under the influence of drugs, alcohol or intoxicating medication.
- ✗ **DO NOT** exceed the rated capacity of the jack.
- ✗ **DO NOT** allow the vehicle to move during lifting or lowering.
- ✗ **DO NOT** jack vehicle if there is a risk of spillage of fuel, battery acid, or other dangerous substances.
- ✗ **DO NOT** work under the vehicle until appropriately rated axle stands have been correctly positioned.
- ✗ **DO NOT** use the jack for any purpose other than its intended use. This jack is designed for lifting vehicles only. Never use it to lift a person, as this can result in serious injury or death. Always follow proper operating procedures and safety guidelines to ensure safe and reliable use.
- ✗ **DO NOT** use in severe weather conditions, risk assess the task.
- ✓ When not in use store jack, fully lowered, in a safe, dry, childproof area.
- ✓ If more than 400N of effort is generated in lifting, the efforts shall be lowered by an additional person.
- ✓ Jacks shall be maintained and repaired in accordance with the manufacturer's instructions. Such maintenance and repair shall be carried out by qualified persons.
- ✓ No modifications shall be carried out which adversely affect the compliance of the jack with the standard.
- ✓ Check the state of the markings and that the markings remain as the initial one.
- ✓ Jacks shall be maintained and repaired in accordance with the manufacturer's instructions. Such maintenance and repair shall be carried out by qualified persons.
- ✓ No modifications shall be carried out which adversely affect the compliance of the jack with the standard.
- ✓ Check the state of the markings and that the marking remain as the initial one.
- ✓ A scissor jack intended for direct contact with food must be made from food-grade, non-toxic, and corrosion-resistant materials such as stainless steel. Its surfaces should be smooth, free of coatings that could flake or contaminate food, and designed for easy cleaning and disinfection. The jack must comply with applicable food-contact and hygiene standards to ensure safe use in food-processing environments.
- ✓ Sea ship operations face restrictions for safety, environmental protection, and legal compliance.

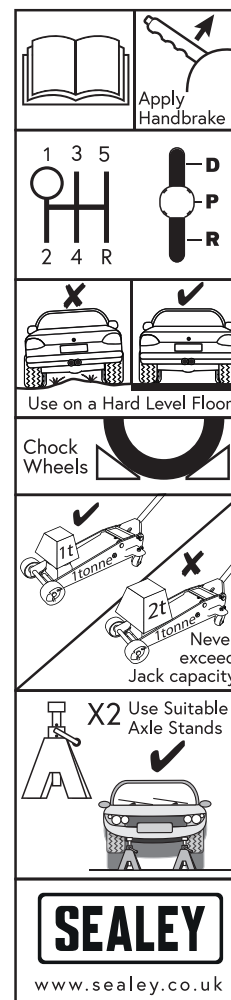

Rules cover navigation, cargo handling, waste disposal, and can be limited by weather or port authority regulations.

- ❑ **WARNING! DO NOT** use a scissor jack in windy conditions, as strong winds can cause instability and may lead to the vehicle shifting or the jack tipping over. Always operate the jack on stable, level ground and only in calm weather to ensure safe lifting.

#### 1.1. CENTRE OF GRAVITY

The centre of gravity of a scissor jack shifts as it lifts a load. When the jack is lowered, its centre of gravity is low and stable, but as it rises, the centre of gravity moves upward and toward the load, reducing stability. For this reason, it is essential to use a scissor jack on firm, level ground to prevent tipping or movement during lifting.

#### 1.2. RESIDUAL RISKS THAT REMAIN

Even when all safety precautions are followed, certain residual risks may remain, including the potential for the vehicle to shift unexpectedly, the jack to lose stability on uneven or contaminated surfaces, or pinch points that may cause injury during operation. There is also a risk of mechanical failure due to unseen wear or material fatigue, as well as hazards from handling heavy components or working in low-visibility conditions. Users should remain alert, monitor the jack and vehicle stability continuously, and avoid placing any part of the body beneath a vehicle unless it is securely supported by approved jack stands.

#### 1.3. APPROPRIATE TRANSPORT AND HANDLING

When transporting or handling the scissor jack, always use the provided storage bag to carry it safely and prevent damage. Keep the jack in an upright position, avoid dropping or striking it, and do not exceed its weight limits when lifting or moving. Ensure hands and fingers are clear of pinch points, and handle the jack on stable surfaces to prevent accidental tipping. Proper transport and handling help maintain the jack's functionality, markings, and safety during use.

## 2. INTRODUCTION

Heavy-duty 2 Tonne scissor jack kit for reliable roadside or workshop use. Includes Tesla-specific and universal pinch weld rubber pads to prevent damage. Supplied with a lug wrench, 17-19 and 21-23mm double ended wheel sockets and reversible ratchet lifting handle for fast wheel removal and replacement. Compatible with most electric, petrol and diesel SUV's, MPV's and other vehicles. Corrosion-resistant materials ensure long-lasting performance. Simple mechanical operation requires no power source. Wide base enhances stability, ideal for professional roadside assist or mobile repair services. Storage bag included to keep your car jack kit organized and ready for use.

## 3. SPECIFICATION

Model No:	59M
Applicable Standards:	EN 1494
Capacity:	2 tonne
Closed Length:	485mm
Maximum Height:	420mm
Minimum Height:	100mm
Nett Weight:	4.7kg
Lifting Range:	250 - 385mm

## 4. OPERATION

#### 4.1. PREPARATION

- 4.1.1. Park the vehicle on a firm, level surface, shift it into Park (for automatic transmissions) or 1st gear (for manual transmissions), apply the parking brake fully. Place wheel chocks on the wheels opposite the lifting point, then locate the manufacturer-recommended lift point under the vehicle. Position the scissor jack beneath this lift point, ensuring the lifting saddle is centered correctly and the jack's base plate sits flat and stable on the ground.

#### 4.2. LIFTING THE VEHICLE

- 4.2.1. Insert the handle or wrench onto the screw shaft and turn it clockwise to raise the jack, continuing until the saddle makes firm contact with the lift point. Verify that the jack is vertical and stable, then keep turning clockwise to lift the vehicle to the desired height. If you will be working beneath the vehicle, immediately place jack stands securely under the frame before proceeding.

#### 4.3. LOWERING A VEHICLE

- 4.3.1. Ensure all tools, parts, and jack stands are removed from beneath the vehicle, then slowly turn the handle counterclockwise to lower the jack. Continue lowering until the vehicle rests securely on the ground, and once fully supported, remove the jack from under the vehicle.

#### 4.4. IN THE EVENT OF MALFUNCTION OR BREAKDOWN:

If the load fails to lower:

Use a functioning jack to raise the vehicle high enough to reinstall the axle stands.

Remove the malfunctioning jack, then remove the axle stands.

#### 4.5. HANDLING OF LOADS, THE NATURE OF WHICH COULD LEAD TO DANGEROUS SITUATIONS

Certain loads can create hazardous situations when using a scissor jack. Avoid lifting overloaded, unstable, or unevenly balanced vehicles, as this may cause the jack to collapse or the load to shift. Always ensure the load is within the rated capacity, properly positioned on the lifting point, and supported on a firm, level surface.

- ❑ **IMPORTANT:** NO RESPONSIBILITY IS ACCEPTED FOR INCORRECT USE OF THE PRODUCT.

## 5. MAINTENANCE

**IMPORTANT:** Only fully qualified personnel should attempt maintenance or repair. Jacks shall be maintained and repaired in accordance with the manufactures instructions. Such maintenance and repair shall be carried out by qualified persons.

No modifications shall be carried out which adversely affect the compliance of the jack with the standard. Check the state of the markings and that the markings remain as the initial one.

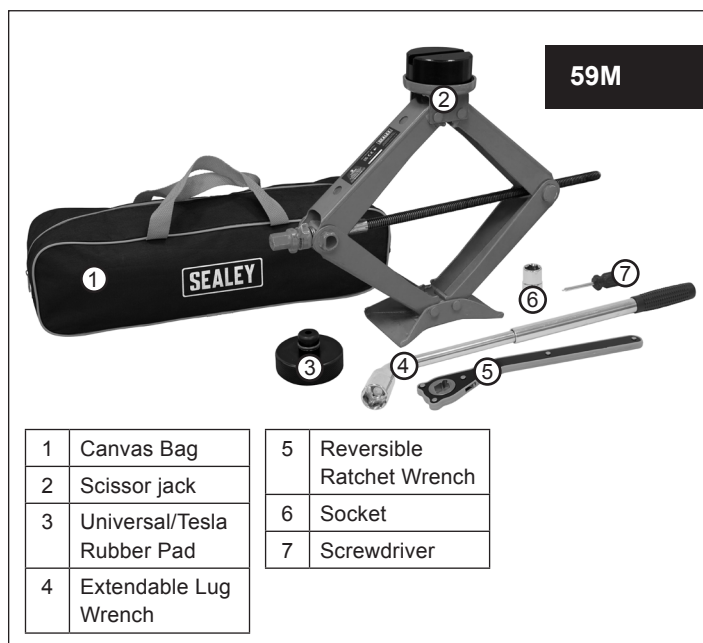

- 5.5.1. Keep the screw shaft lightly lubricated with grease or oil, clean dirt and debris from the jack after each use, inspect it for cracks, bends, or damaged threads before operating, check the condition of the markings and ensure they are maintained in their original state, and store the jack in a dry location to prevent corrosion.
- 5.5.2. Store the scissor jack in a clean, dry location to prevent moisture-related corrosion and damage, and always place it inside the provided storage bag to protect it from dust, dirt, and accidental impact.
- Keep it away from extreme temperatures, direct sunlight, and chemicals that could degrade metal or lubricants. Ensure the jack is fully lowered before storing it, and position it where it cannot fall, be crushed, or otherwise damaged. Using the storage bag also helps preserve the jack's markings and overall operating condition.

## 6. END OF LIFE

### 6.1. DE-COMMISSIONING THE JACK

Should the jack become completely unserviceable dispose of the jack according to local regulations.



#### ENVIRONMENT PROTECTION

Recycle unwanted materials instead of disposing of them as waste. All tools, accessories and packaging should be sorted, taken to a recycling centre and disposed of in a manner which is compatible with the environment. When the product becomes completely unserviceable and requires disposal, drain any fluids (if applicable) into approved containers and dispose of the product and fluids according to local regulations.



REGISTER YOUR  
PURCHASE HERE

**Note:** It is our policy to continually improve products and as such we reserve the right to alter data, specifications and component parts without prior notice. Please note that other versions of this product are available. Important: No Liability is accepted for incorrect use of this product.

**Warranty:** Guarantee is 12 months from purchase date, proof of which is required for any claim.

**Jack Sealey Ltd t/a Sealey Group**, Kempson Way, Suffolk Business Park, Bury St Edmunds, Suffolk, IP32 7AR UK  
**Jack Sealey (EU) Ltd t/a Sealey Group**, Farney Street, Carrickmacross, Co. Monaghan, A81 PK68 Ireland  
**Tel:** 01284 757500 • **Email:** sales@sealey.co.uk • **Web:** www.sealey.co.uk